



## ABOUT THE PROJECT

Time was of the essence when this engineering and construction firm decided to move to a new, updated space. Substantial financial penalties for not vacating their existing offices on time made the proposed six-month conventional construction schedule unworkable; and the firm wanted to use sustainable construction to reflect their commitment to the environment. With DIRTT at the table from the onset, the build schedule for the six floors was reduced to 14 weeks. "There's not a chance we would have made the schedule without a major, different way of thinking about labor," the client's architect commented; and the accuracy and creative flexibility of DIRTT's ICE® design/manufacturing software ensured a superior fit, finish and aesthetic, surprising skeptics who equated "prefab" with "poor quality."

## SOLUTIONS

- Pivot, barn, frameless glass barn doors
- Solid and glass walls
- DIRTT Power
- DIRTT Accessories
- Third Party components:
- Acoustical management, card readers, mag locks

## FINISHES

- Clear tempered glass
- Chromacoat
- Powder coat
- Anodized aluminum
- Magnetic marker board
- Tackable tile

## ARCHITECT/DESIGNER

Margulies Perruzzi Architects

## DISTRIBUTION PARTNER

Strategic Workspaces

## GENERAL CONTRACTOR

Structure Tone

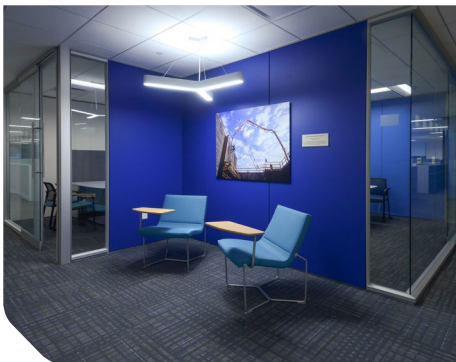

DIRTT reduced the six-month conventional construction schedule to 14 weeks.

